

1 253 Victoria Road

Lower Floor Total: 79 SQ.FT.

NISF Work/Live Total: 218 SQ.FT.

Lower Floor and
NISF Work/ LiveTotal: 297 SQ.FT.

NISF Work/Live
Not Included In SQ.FT.

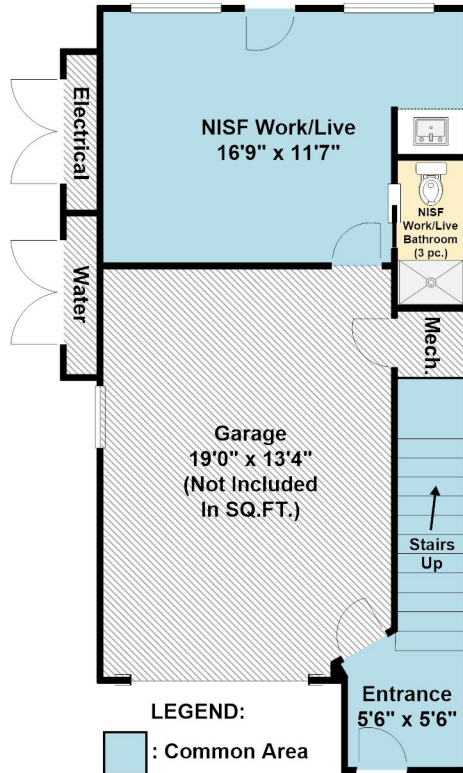

LEGEND:

- : Common Area
- : Bathroom
- : Bedroom
- : Deck

Main Floor Total: 638 SQ.FT.

Total: 1341 SQ.FT.

Total with
NISF Work/Live: 1559 SQ.FT.

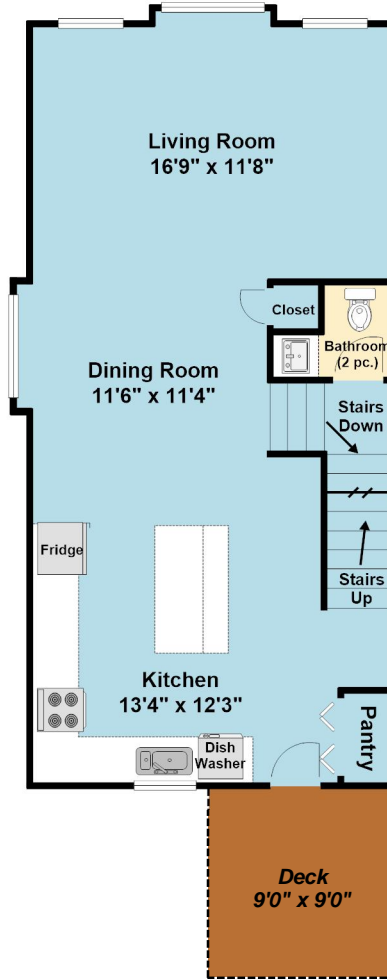

Upper Floor Total: 624 SQ.FT.

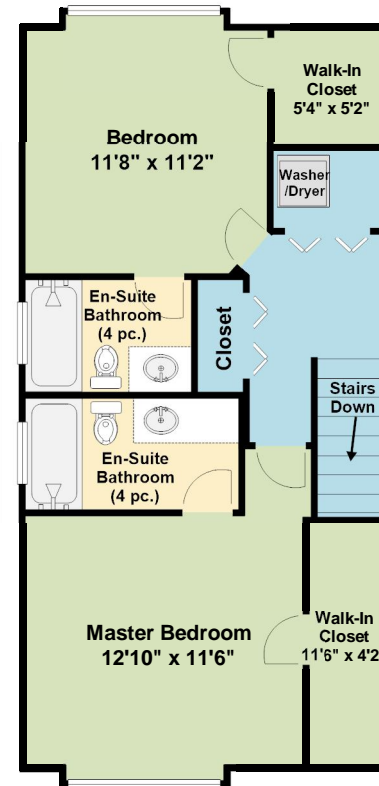

LOWER

Entrance :: 5'6" x 5'6"

NISF WORK/LIVE

NISF Work/Live :: 16'9" x 11'7"

MAIN

Living Room :: 16'9" x 11'8"

Dining Room :: 11'6" x 11'4"

Kitchen :: 13'4" x 12'3"

UPPER

Master Bedroom :: 12'10" x 11'6"

Bedroom :: 11'8" x 11'2"

Made for the Exclusive
use of Jason Simard of
RE/MAX of Nanaimo Realty Group
by James Sigouin as
measured July 26th, 2018